

DN conduits

## Corrugated conduit systems

### DN conduits



You can find in this chapter:

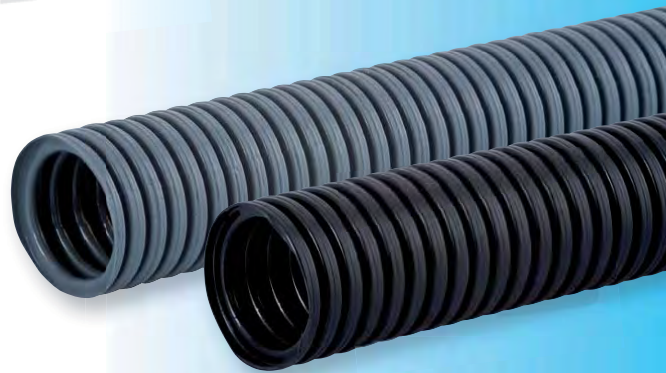

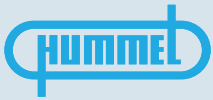



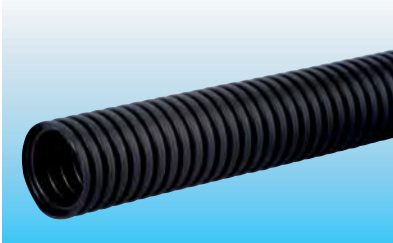

- DN conduit made of polyamide
- SM fittings for fast mounting of DN conduit
- snap elbow systems for DN conduit



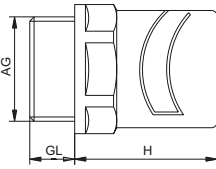

## DN conduits

<b>SM-WS-PA</b>					<b>DN</b>																																																					
	<b>Material</b>	Polyamide																																																								
	<b>Operating Temperature</b>	-40 °C – 110 °C (-40 °F – 230 °F)																																																								
	<b>Colours</b>	grey (RAL 7031), black (RAL 9005)																																																								
<table border="1" style="width: 100%; border-collapse: collapse; text-align: center;"> <thead> <tr> <th style="padding: 5px;">Size DN</th> <th style="padding: 5px;">Typ</th> <th style="padding: 5px;">d mm</th> <th style="padding: 5px;">D mm</th> <th style="padding: 5px;">Number grey</th> <th style="padding: 5px;">Number black</th> </tr> </thead> <tbody> <tr><td>10</td><td>PA</td><td>10</td><td>13</td><td>1.510.0900.14</td><td>1.510.0901.14</td></tr> <tr><td>12</td><td>PA</td><td>12</td><td>15,5</td><td>1.510.1100.14</td><td>1.510.1101.14</td></tr> <tr><td>14</td><td>PA</td><td>14</td><td>18,5</td><td>1.510.1300.14</td><td>1.510.1301.14</td></tr> <tr><td>17</td><td>PA</td><td>16,5</td><td>21</td><td>1.510.1600.14</td><td>1.510.1601.14</td></tr> <tr><td>23</td><td>PA</td><td>22,5</td><td>28,5</td><td>1.510.2100.14</td><td>1.510.2101.14</td></tr> <tr><td>29</td><td>PA</td><td>28,5</td><td>34,5</td><td>1.510.2900.14</td><td>1.510.2901.14</td></tr> <tr><td>37</td><td>PA</td><td>36</td><td>42</td><td>1.510.3600.14</td><td>1.510.3601.14</td></tr> <tr><td>50</td><td>PA</td><td>47,5</td><td>54</td><td>1.510.4800.14</td><td>1.510.4801.14</td></tr> </tbody> </table>					Size DN	Typ	d mm	D mm	Number grey	Number black	10	PA	10	13	1.510.0900.14	1.510.0901.14	12	PA	12	15,5	1.510.1100.14	1.510.1101.14	14	PA	14	18,5	1.510.1300.14	1.510.1301.14	17	PA	16,5	21	1.510.1600.14	1.510.1601.14	23	PA	22,5	28,5	1.510.2100.14	1.510.2101.14	29	PA	28,5	34,5	1.510.2900.14	1.510.2901.14	37	PA	36	42	1.510.3600.14	1.510.3601.14	50	PA	47,5	54	1.510.4800.14	1.510.4801.14
Size DN	Typ	d mm	D mm	Number grey	Number black																																																					
10	PA	10	13	1.510.0900.14	1.510.0901.14																																																					
12	PA	12	15,5	1.510.1100.14	1.510.1101.14																																																					
14	PA	14	18,5	1.510.1300.14	1.510.1301.14																																																					
17	PA	16,5	21	1.510.1600.14	1.510.1601.14																																																					
23	PA	22,5	28,5	1.510.2100.14	1.510.2101.14																																																					
29	PA	28,5	34,5	1.510.2900.14	1.510.2901.14																																																					
37	PA	36	42	1.510.3600.14	1.510.3601.14																																																					
50	PA	47,5	54	1.510.4800.14	1.510.4801.14																																																					

<b>SM-N</b>					<b>Metr., PG, NPT</b>																																																																																												
	<b>Material</b>	Polyamide																																																																																															
	<b>Protection</b>	IP 54, with O-Ring with fixed conduit mounting IP 65																																																																																															
	<b>Operating Temperature</b>	-20 °C – 80 °C (-4 °F – 176 °F)																																																																																															
	<b>Colours</b>	grey (RAL 7031), black (RAL 9005)																																																																																															
<table border="1" style="width: 100%; border-collapse: collapse; text-align: center;"> <thead> <tr> <th style="padding: 5px;">AG</th> <th style="padding: 5px;">GL mm</th> <th style="padding: 5px;">H mm</th> <th style="padding: 5px;"> mm</th> <th style="padding: 5px;">DN</th> <th style="padding: 5px;">Number grey</th> <th style="padding: 5px;">Number black</th> </tr> </thead> <tbody> <tr><td>M 16 x 1,5</td><td>8</td><td>23</td><td>17</td><td>10</td><td>1.511.1600.50</td><td>1.511.1601.50</td></tr> <tr><td>M 20 x 1,5</td><td>9</td><td>28</td><td>24</td><td>14</td><td>1.511.2000.50</td><td>1.511.2001.50</td></tr> <tr><td>M 25 x 1,5</td><td>11</td><td>32</td><td>35</td><td>23</td><td>1.511.2500.50</td><td>1.511.2501.50</td></tr> <tr><td>M 32 x 1,5</td><td>11</td><td>35</td><td>42</td><td>29</td><td>1.511.3200.50</td><td>1.511.3201.50</td></tr> <tr><td>PG 9</td><td>8</td><td>23</td><td>17</td><td>10</td><td>1.511.0900.14</td><td>1.511.0901.14</td></tr> <tr><td>PG 11</td><td>8</td><td>25</td><td>21</td><td>12</td><td>1.511.1100.14</td><td>1.511.1101.14</td></tr> <tr><td>PG 13,5</td><td>9</td><td>28</td><td>24</td><td>14</td><td>1.511.1300.14</td><td>1.511.1301.14</td></tr> <tr><td>PG 16</td><td>10</td><td>29</td><td>27</td><td>17</td><td>1.511.1600.14</td><td>1.511.1601.14</td></tr> <tr><td>PG 21</td><td>11</td><td>32</td><td>35</td><td>23</td><td>1.511.2100.14</td><td>1.511.2101.14</td></tr> <tr><td>PG 29</td><td>11</td><td>35</td><td>42</td><td>29</td><td>1.511.2900.14</td><td>1.511.2901.14</td></tr> <tr><td>PG 36</td><td>13</td><td>41</td><td>50</td><td>37</td><td>1.511.3600.14</td><td>1.511.3601.14</td></tr> <tr><td>PG 48</td><td>14</td><td>46</td><td>64</td><td>50</td><td>1.511.4800.14</td><td>1.511.4801.14</td></tr> </tbody> </table>							AG	GL mm	H mm	 mm	DN	Number grey	Number black	M 16 x 1,5	8	23	17	10	1.511.1600.50	1.511.1601.50	M 20 x 1,5	9	28	24	14	1.511.2000.50	1.511.2001.50	M 25 x 1,5	11	32	35	23	1.511.2500.50	1.511.2501.50	M 32 x 1,5	11	35	42	29	1.511.3200.50	1.511.3201.50	PG 9	8	23	17	10	1.511.0900.14	1.511.0901.14	PG 11	8	25	21	12	1.511.1100.14	1.511.1101.14	PG 13,5	9	28	24	14	1.511.1300.14	1.511.1301.14	PG 16	10	29	27	17	1.511.1600.14	1.511.1601.14	PG 21	11	32	35	23	1.511.2100.14	1.511.2101.14	PG 29	11	35	42	29	1.511.2900.14	1.511.2901.14	PG 36	13	41	50	37	1.511.3600.14	1.511.3601.14	PG 48	14	46	64	50	1.511.4800.14	1.511.4801.14
AG	GL mm	H mm	 mm	DN	Number grey	Number black																																																																																											
M 16 x 1,5	8	23	17	10	1.511.1600.50	1.511.1601.50																																																																																											
M 20 x 1,5	9	28	24	14	1.511.2000.50	1.511.2001.50																																																																																											
M 25 x 1,5	11	32	35	23	1.511.2500.50	1.511.2501.50																																																																																											
M 32 x 1,5	11	35	42	29	1.511.3200.50	1.511.3201.50																																																																																											
PG 9	8	23	17	10	1.511.0900.14	1.511.0901.14																																																																																											
PG 11	8	25	21	12	1.511.1100.14	1.511.1101.14																																																																																											
PG 13,5	9	28	24	14	1.511.1300.14	1.511.1301.14																																																																																											
PG 16	10	29	27	17	1.511.1600.14	1.511.1601.14																																																																																											
PG 21	11	32	35	23	1.511.2100.14	1.511.2101.14																																																																																											
PG 29	11	35	42	29	1.511.2900.14	1.511.2901.14																																																																																											
PG 36	13	41	50	37	1.511.3600.14	1.511.3601.14																																																																																											
PG 48	14	46	64	50	1.511.4800.14	1.511.4801.14																																																																																											

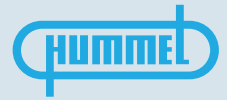

## DN conduits

SM-W

Metr., PG, NPT



Material	Polyamide
O-Ring	NBR
Protection	IP 54 with fixed conduit mounting IP 65
Operating Temperature	-20 °C – 80 °C (-4 °F – 176 °F)
Colours	black (RAL 9005)

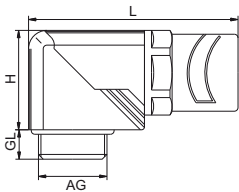

AG	GL mm	H mm	L mm	mm	fits to SM-Conduit DN	Number
M 16 x 1,5	8	23	43	19	10	1.513.1601.50
M 20 x 1,5	9	30,5	52	24	14	1.513.2001.50
M 25 x 1,5	11	40	70	33	23	1.513.2501.50
M 32 x 1,5	11	51,5	83	42	29	1.513.3201.50
PG 9	8	23	43	19	10	1.513.0901.14
PG 11	8	27	48	22	12	1.513.1101.14
PG 13,5	9	30,5	52	24	14	1.513.1301.14
PG 16	10	32,5	56	27	17	1.513.1601.14
PG 21	11	40	70	33	23	1.513.2101.14
PG 29	11	51,5	83	42	29	1.513.2901.14
NPT 3/8"	15	23	43	19	10	1.513.3801.70
NPT 1/2"	13	32,5	56	27	17	1.513.1217.70
NPT 3/4"	13	40	70	33	23	1.513.3401.70
NPT 1"	15	51,5	83	42	29	1.513.1001.70