

Clevises with male thread

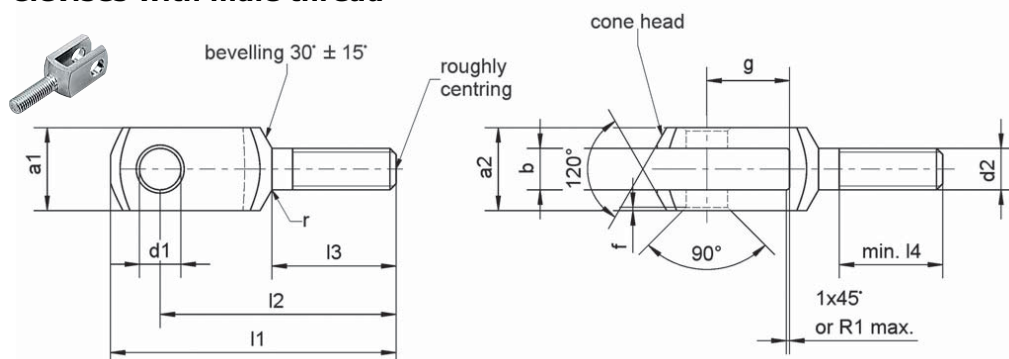

Example for ordering:

Clevis with male thread

d1=10 mm, slot length g=20 mm, with metric regular thread d2=M 10x1.5;

Clevis with male thread G 10x20, M 10x1.5

Order number: 10 42 0010 0020

mbo standard 42

	Order number	d1 H 9	g ± 0.5	Size ²⁾		a2 + 0.50 - 0.20	b + 0.7 + 0.15	d2 ¹⁾		f ± 0.2	l1 ± 0.2	l2 ± 0.4	l3 ± 0.2	l4	r ³⁾	Mass (7.85 kg/dm ³) kg ≈
				h 11				Regular thread	Fine-pitch thread							
G 6x12	10 42 0006 0012	6	12	12	12	6	M 6x1	-	0.5	44	37	20	15	0.8	0.015	
G 8x16	10 42 0008 0016	8	16	16	16	8	M 8x1.25	-	0.5	57	47	25	20	0.8	0.036	
G 10x20	10 42 0010 0020	10	20	20	20	10	M 10x1.5	-	0.5	69	57	30	25	0.8	0.068	
G 12x24	10 42 0012 0024	12	24	24	24	12	M 12x1.75	-	0.5	82	68	35	30	0.8	0.122	
G 14x28	10 42 0014 0028	14	28	27	27	14	M 14x2	-	1	94	78	40	35	1.2	0.171	
G 16x32	10 42 0016 0032	16	32	32	32	16	M 16x2	-	1	108	89	45	40	1.2	0.288	
G 20x40	10 42 0020 0040	20	40	40	40	20	M 20x2.5	-	1	134	109	55	50	1.5	0.55	

¹⁾ code for thread:
regular thread no code

²⁾ for semifinished products, tolerance h11 according to DIN 178

³⁾ radius or 45° beveling (at manufacturer's choice)

Material:

1.0718 (11SMnPb30+C)

alternative:

stainless steel 1.4305 (X8CrNiS18-9)



Surface protection:

polished oiled or at manufacturer's choice

optional: phosphatized and oiled, electroplated
galvanized, passivated in white-blue (silver/clear)
or yellow

Special version:

left-handed and other threads or special slot widths
"b" and transversal hole upon request

Retaining:

with bolts (mbo catalog section 4 and 6) and
retainers (mbo catalog section 13) or washer and cotter pin;
also see clevis joint combinations
(mbo catalog section 11)

Special versions upon request